

Instructions

www.easyrefills.com.au

Epson T0492/93/94/95/96

Kit Code: K65CLR

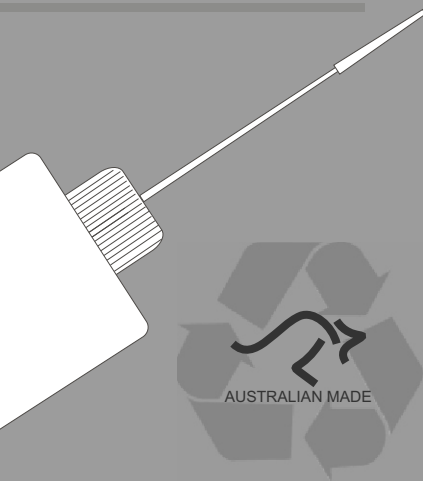

Easyrefills kit

Kit Contents:

5 x ink bottles (cyan,magenta,yellow,
light cyan, light magenta)
1 x plastic gloves
1 x hand drill
1 x absorbent pad
3 x plugs

Extra's Needed:

1 x Chip resetter (available from Easy
refills)

Preparation:

- Put on the gloves supplied
- Cover your work area in newspaper
in case of accidental spillage.
- Read these instructions thoroughly
- Remove the cartridge from your
printer (only do this when
ready to refill.)

NB: Ink stains so we would
recommend you wear old
clothes or an apron when
refilling.

Preparation

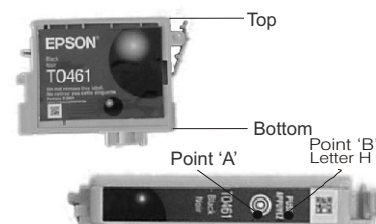

Locate point 'A'+ 'B' on the top of the cartridge.
Note: Look for a round white dot on the
original sticker just below the word 'push'.
Point 'B' is located on H in push.

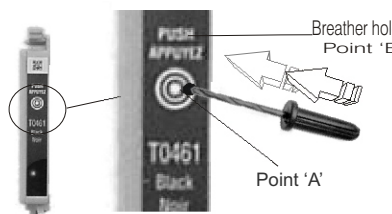

A refilling hole and breather hole must now
be made at point 'A'+ 'B'. Use the drill tool
provided to make this hole. Point 'A' is
located just to the left of centre of the white dot.
Note: Do not drill in the centre of the white dot.

1 Step One

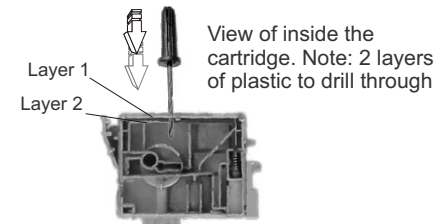

Once you have drilled through the first
layer of plastic, you will meet another layer
of resistance. This must also be drilled
through until no resistance is felt.

2 Step Two

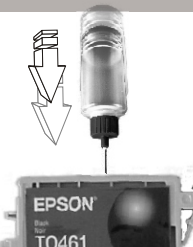

Insert the refill needle into the hole you have
just made. Push the needle as far down
into the cartridge as possible. Note: Do not
force the needle.

3 Step Three

4 Step Four

5 Step Five



S-l-o-w-l-y and gently squeeze the ink refill
bottle to force ink into the cartridge. This must
be done with very little pressure, pulling the
needle upward as you go. **When ink is
visible** at the top of the hole **stop** squeezing.

6 Step Six



Insert the plug provided into the refilling
hole and point 'B'. Gently squeeze the sides
of the cartridge while resealing the hole. An
tight seal must be formed. Cover the hole
and plug with the sticker provided.

7 Step Seven

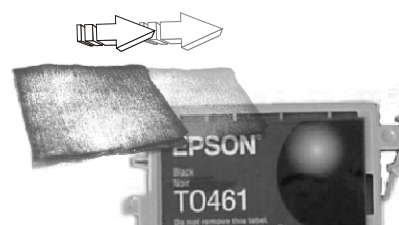

Using the pad provided, clean any foreign
materials or excess ink from the cartridge.
Due to the nature of this cartridge, some
leaking may occur. If leaking occurs, simply
blot with tissue until the leaking stops.

8 Step Eight



Before installing the cartridge into your
printer, the chip must be reset using a chip
re-setter. If you do not have a chip re-setter,
one can be purchased from Easyrefills.

9 Step Nine

Q: Cartridge will not print?

A: If the cartridge does not print after
refilling, rest the print nozzles on a
wet tissue. This will draw ink through
the nozzles. Leave for 10 minutes
and try printing again.

Q: Prints with streaks through text or image?

A: This could mean that the print nozzles
are blocked, therefore preventing ink to
flow freely. To correct this problem use
the printers cleaning routine. If this does
not work, rest the print nozzles on a wet
tissue. This will draw ink through the
nozzles. Leave for 10 minutes and try
printing again.

Q: Ink stains on hands and clothes?

A: To clean your hands, first wash
thoroughly in soap and warm water.
If the stains persist, try using bathroom
cleaner. It may take several washes to
remove the ink. There is no real solution
to ink stained clothes. However if you
are using a dy cleaner, you can tell them
the ink is based upon water soluble dye
with ethylene glycol added.

Phone Support
1300 730 018

10 Step Ten

Trouble shooting

Printer Compatibility:

Epson Stylus Photo RX510, R210, R310

Cartridge Stats:

Chipped Cartridge: Yes
Colour Cyan,Magenta,Yellow,
Light cyan, Light magenta
Ink Capacity: 15 ml
Weight when full: 36 grams

Number of refills per kit:

6 refills per kit

Easyrefills manufacturers all refill kits at it's
Queensland headquarters. Importing the
finest quality American made inks that are
in most cases better than or equal to
original manufacturers specifications. Each
kit has a shelf life of two years and is
covered by a 100% guarantee.

Copyright 2004 Easyrefills. All names and numbers used are
registered trademarks of their respective owners.

www.easyrefills.com.au

General Information