

Instructions

www.easyrefills.com.au

HP 940XL

Kit Code: K67BK

Easyrefills kit

Kit Contents:

- 3 x 40ml ink bottles (Black)
- 1 x plastic gloves
- 1 x screw drill tool
- 1 x absorbent pad
- 2 x ball plugs
- 1 x syringe
- 1 x blunt needle

Preparation:

- Put on the gloves supplied
- Cover your work area in newspaper in case of accidental spillage.
- Read these instructions thoroughly
- Remove the cartridge from your printer (only do this when ready to refill.)

NB: Ink stains so we would recommend you wear old clothes or an apron when refilling.

Preparation



Cut the label at the joint between the top and bottom cap of the cartridge. Pull the bottom cap off the cartridge.

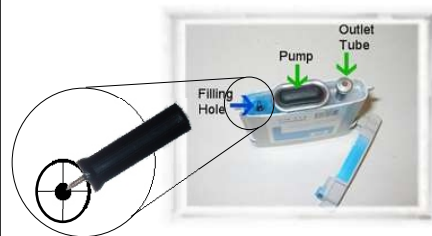

Using the screw drill tool, screw into the centre of the rubber sealing plug in the filling hole until a firm grip is made and pull the plug out. Leave the plug on the end of the screw drill tool.

1 Step One



Remove the plunger from the syringe. Put the point of the syringe over the filling hole and blow into the open end (where the plunger was). This expands the mylar bag inside the cartridge so it will accept the ink.

2 Step Two

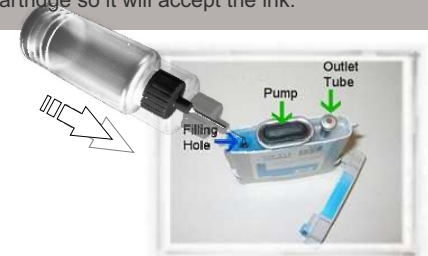

Carefully insert the needle of the ink bottle into the filling hole. **WARNING: DO NOT** allow the needle to press against the bag - even though it is blunt it can still pierce the mylar bag thereby ruining the cartridge.

3 Step Three

4 Step Four

5 Step Five

Trouble shooting

Printer Compatibility:

OFFICEJET 8000, OFFICEJET PRO 8500,
OFFICEJET 8500a

Cartridge Stats:

Colours: Black
Ink Capacity: XL = 60mls
standard = 20mls

Number of refills per kit:

standard cartridge = 6 refills per kit
XL cartridges = 2 refills per kit

Easyrefills manufactures all refill kits at it's Queensland headquarters. Importing the finest quality American made inks that are in most cases better than or equal to original manufacturers specifications. Each kit has a shelf life of two years and is covered by a 100% guarantee.

Copyright 2012 Easyrefills. All names and numbers used are registered trademarks of their respective owners.

www.easyrefills.com.au

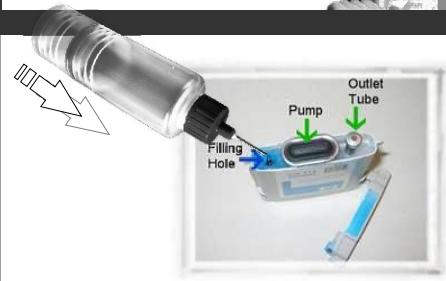

S-l-o-w-l-y squeeze the ink refill bottle to force ink into the reservoir - about half the bottle should go in.

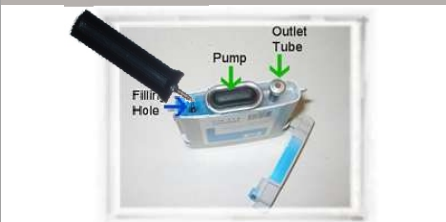

Reseal the cartridge by pushing the rubber plug in while it is still on the screw drill tool and unscrew the tool from the plug. A new plug may be used if the old one is too damaged.

5 Step Five

6 Step Six



Remove excess air from the bag and pump assembly as follows:
*hold cartridge at 45 angle with outlet at top;
*with plunger pushed into syringe, insert needle into outlet;



*press & release pump several times to expel air into the syringe;
*pull back plunger on syringe to remove air from the outlet hole.
Replace cap and tape and install cartridge into your printer. Run the head cleaning utility.

7 Step Seven

8 Step Eight

IMPORTANT INFORMATION

Before you can begin printing you will need to disable the chips on the cartridges. Simply push and hold the 'reset' button on the printer for 5 seconds. If there is no reset button, look for either a 'stop', 'cancel' or 'X'.

The manufacture date is recorded on the chip in these cartridges. It allows the cartridge to operate for two years and then the cartridge will stop working. If the cartridge has been sitting on a shelf for 6 months before you bought it, you only have 18 months left to use it and refill it as many times as you like.

Phone Support
1300 730 018

General Information